

Reg. No:

--	--	--	--	--	--	--	--	--

SIDDHARTH INSTITUTE OF ENGINEERING & TECHNOLOGY:: PUTTUR
(AUTONOMOUS)**B.Tech IV Year I Semester Supplementary Examinations November-2020****ESTIMATION, COSTING AND VALUATION**

(CIVIL ENGINEERING)

Time: 3 hours

Max. Marks: 60

(Answer all Five Units 5 x 12 = 60 Marks)

UNIT-I**1 Write in brief about the following: 12M**

- (i) Detailed estimate.
- (ii) Differentiate between estimating and costing.
- (iii) Plinth area estimate.
- (iv) List out the method for building estimate.

OR**2 Explain the following general items of work involved in the estimation for a building along with the process of calculations: 12M**

- (i) Brick or Stone Masonry with Cement Mortar
- (ii) Damp Proof Course
- (iii) Lintel over openings

UNIT-II**3 a Explain long wall and short wall method. 6M****b Explain Centre line method in detail. 6M****OR****4 Calculate the quantities of the following items for the building shown in figure using Long wall and short wall method 12M**

- (i) Earth work in excavation
- (ii) Brick work in foundation and plinth
- (iii) Brick masonry in CM (1:6) for super structure

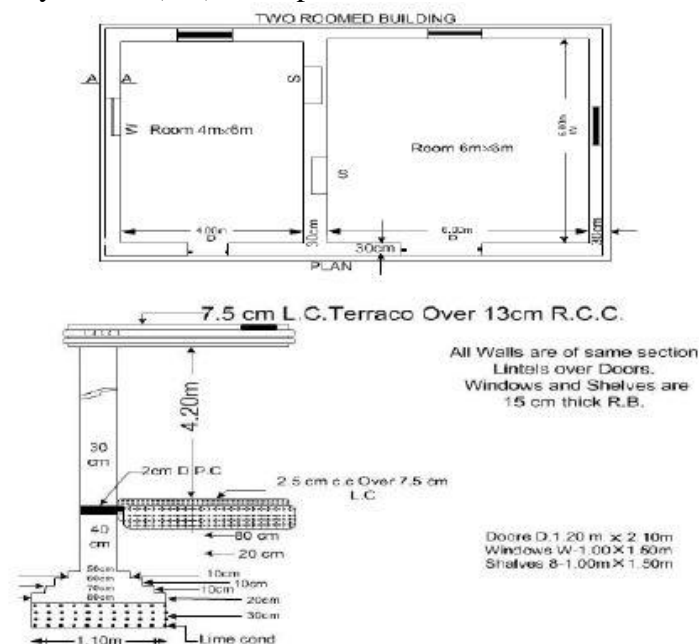

UNIT-III

- 5 **a** List out the general methods for computation of earthwork. Explain. **6M**
b Explain about Lead and lift. **6M**

OR

- 6 The ground levels along the center line of the road are given below. **12M**
 The formation level throughout 80 m length is 102.75. The road has a rising gradient 1 in 40. If the width of the road is 12 m and side slopes 2:1, calculate the quantity of earthwork required by any method.

Chainage in m	0	20	40	60	80
R.L. of Ground	101.5	100.9	101.5	102	102.85

UNIT-IV

- 7 **a** Define contract and briefly explain contract document. **6M**
b List out and explain various types of contracts. **6M**

OR

- 8 Explain the following briefly: **12M**
 (i) Earnest Money Deposit.
 (ii) Security Deposit.
 (iii) Comparative Statement.
 (iv) Termination of contract.

UNIT-V

- 9 **a** Define valuation. Explain briefly the valuation methods. **5M**
b An old building has been purchased by a person @ a cost of Rs.4, 00,000 **7M**
 excluding the cost of land. Calculate the amount of annual sinking fund @ 8% interest assuming the life of the building as 25 years and the scrap value of the building as 10 % of the purchase.

OR

- 10 A building is situated on a land of 250 sq.m. The built up portion is 10 m x 8.5 m. **12M**
 The building is first class type and provided with water supply, sanitary and electric fittings. The age of the building is 10 years. Work out the valuation of the property. Assume plinth area rate as Rs. 20,000 per sq.m and cost of land as Rs. 4500 per sq.m

*** END ***